

**ASTM E-1680-95 AIR & E-1646-95 WATER TEST DATA  
FOR BERRIDGE TEE-PANEL, CEE-LOCK & ZEE-LOCK ROOF PANELS  
(Panels only; No substrates)**

**AIR TEST PROCEDURE**

**ASTM E 1680-95:** Standard test method for air leakage through roof panel assemblies. All tests conducted using static air pressure difference. Tee-Panel was tested with clips and snap-on seam cap with vinyl weatherseal. Cee-Lock and Zee-Lock standing seam roof panels were tested with Continuous Cee-Rib/Zee-Rib with Vinyl Weatherseal strip. Zee-Lock Double Lock was tested with Continuous Zee-Rib and no weatherseal.

**WATER TEST PROCEDURE**

**ASTM E 1646-95:** Standard test method for water penetration of roof panel assemblies by uniform static air pressure difference. Test assemblies used for the three Berridge panels shown below was the same as that utilized for the air leakage test described at left.

ASTM E-1680-95 AIR & E-1646-95 WATER TEST DATA  
FOR BERRIDGE CEE-LOCK & ZEE-LOCK ROOF PANELS  
Berridge Manufacturing Company

**BERRIDGE TEE-PANEL**

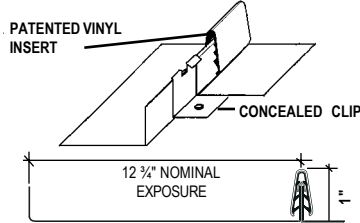

ASTM E-1680-95 Air Infiltration		ASTM E-1646-95 Water Penetration	
Pressure Differential	Leakage Rate	Pressure Differential	Leakage Rate
6.24 PSF	0.8 CFM	8.0 PSF	NOLEAKAGE

*Test assembly was a nominal 37" wide x 72" deep and incorporated two (2) 1" high standing seams. The panel specimen was fastened onto a 2" x 4" wood buck with a total of thirty eight (38) fasteners: Eleven (11) were used at each jamb and six (6) across the head and sill. All tests were conducted with the panel in a horizontal position. The static air infiltration test was conducted with a uniform static air pressure differential of 6.24 PSF. (This equates to a basic wind speed of 50 mph). A static pressure differential of 8.0 PSF which equates to 56 mph was used in the Water Penetration test.*

**BERRIDGE CEE-LOCK**

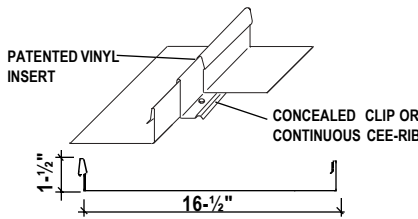

6.24 PSF	0.2 CFM	15.0 PSF	NOLEAKAGE
----------	---------	----------	-----------

*Test assembly was a 3' 3" x 6' 0" panel attached and sealed to a 4' x 6' frame, attached a horizontal-mounted test platform. Tested with Continuous Cee-Rib with Vinyl Weatherseal strip. The static air infiltration test was conducted with a uniform static air pressure differential of 6.24 PSF. (This equates to a basic wind speed of 50 mph). A static pressure differential of 15.0 PSF which equates to 77 mph was used in the Water Penetration test.*

**BERRIDGE ZEE-LOCK SINGLE LOCK**

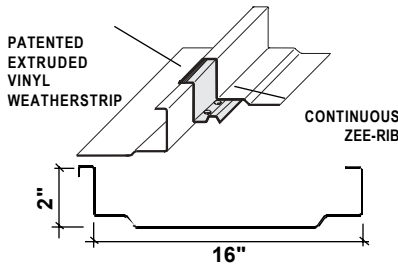

6.24 PSF	0.9 CFM	15.0 PSF	NOLEAKAGE
----------	---------	----------	-----------

*Test assembly was a 3' 0" x 6' 0" panel (3 single-locked 2" high standing seams) attached and sealed to a 3' x 6' open metal frame, attached to a horizontal mounted test platform. Tested with Continuous Zee-Rib with Vinyl Weatherseal strip. The static air infiltration test was conducted with a uniform static air pressure differential of 6.24 PSF. (This equates to a basic wind speed of 50 mph). A static pressure differential of 15.0 PSF which equates to 77 mph was used in the Water Penetration test.*

**BERRIDGE ZEE-LOCK DOUBLE-LOCK**

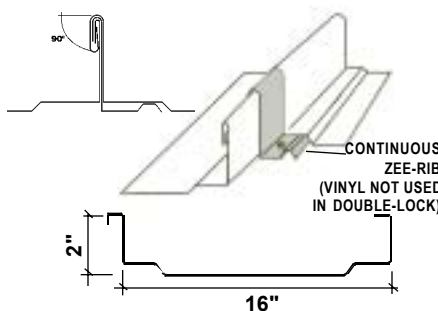

6.24 PSF	1.1 CFM	6.24 PSF	NOLEAKAGE
----------	---------	----------	-----------

*Test assembly was a 3' 0" x 6' 0" panel attached and sealed to a 3' x 6' frame (3 double-locked 2" high standing seams) attached and sealed to a 3' x 6' open metal frame, attached to a horizontal mounted test platform. Tested with Continuous Zee-Rib with no Vinyl Weatherseal strip. The static air infiltration test was conducted with a uniform static air pressure differential of 6.24 PSF. (This equates to a basic wind speed of 50 mph). A static pressure differential of 15.0 PSF which equates to 77 mph was used in the Water Penetration test.*

7

Metal Roofing & Siding Products  
Moisture & Thermal Protection:

